

## EZ-TEE IPS HUB FOR GRAVITY APPLICATIONS

HUB END ACCEPTS IPS PIPE.  
CONTACT CUSTOMER  
SERVICE FOR BRAND  
SPECIFIC CONNECTIONS.

CONTACT CUSTOMER  
SERVICE FOR WALL  
THICKNESS CHART

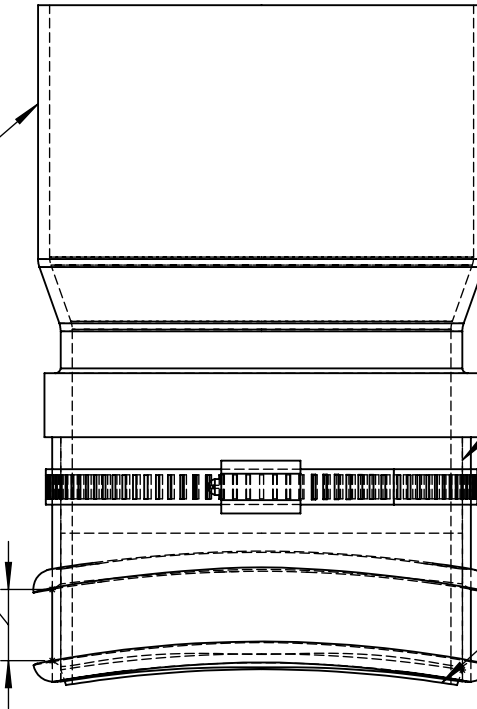

SPIGOT END PVC SDR35 DIAMETERS  
4" - 15" ,CONFORMS TO ASTM D3034

PVC STUB PROFILE MADE TO MATCH  
CORRESPONDING MAINLINE.

PVC STUB SIZE	4" [100mm]	6" [150mm]	8" [200mm]	10" [250mm]	12" [300mm]
HOLE DIAMETER	4.5"[114mm]	6.5"[165mm]	8.75"[222mm]	10.875"[276mm]	12.875"[327mm]



Galaxy Plastics Ltd.

DIMENSIONS ARE  
IN INCHES UNLESS  
OTHERWISE  
SPECIFIED

TOLERANCES:  
LINEAR:  $\pm 1/2"$   
ANGULAR:  $\pm 2^\circ$

ADDRESS:  
21450 NW WEST UNION Rd,  
HILLSBORO, OR  
97124  
1-877-814-2803

REV	DESCRIPTION	DATE	DRAWN	GOWTHAM	09-JUL-2025
0	INITIAL DRAWING	09-JUL-2025	CHECKED	ROB JULIEN	09-JUL-2025
			APPROVED		
			Q.A.		
			COMMENTS:		

DESCRIPTION

**EZ-TEE IPS HUB FOR  
GRAVITY APPLICATIONS**

PART NUMBER

**ZZZZ**

REV

**0**

MATERIAL :

SCALE: 1 : 3

WEIGHT:

SHEET 1 OF 2

## EZ-TEE IPS HUB FOR GRAVITY APPLICATIONS

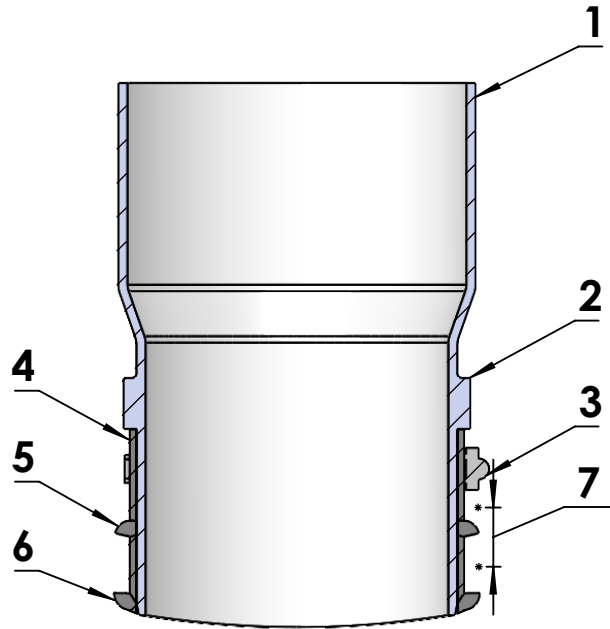

PART #	PART NAME	MATERIAL
1	IPS HUB	PVC SDR 35 ASTM
2	EZ STOP RING	
3	STAINLESS STEEL GEAR CLAMP	#304 STAINLESS STEEL GEAR CLAMP [#316 SS AVAILABLE ON REQUEST]
4	RUBBER BOOT	RUBBER BOOT MADE FROM RUBBER WHICH CONFORMS TO ASTM F477
5	OUTSIDE RIB	
6	INSIDE RIB	
7	RIB OPENING VARIES TO MATCH MAINLINE PIPE WALL THICKNESS	



Galaxy Plastics Ltd.

DIMENSIONS ARE  
IN INCHES UNLESS  
OTHERWISE  
SPECIFIED

TOLERANCES:  
LINEAR:  $\pm 1/2"$   
ANGULAR:  $\pm 2^\circ$

ADDRESS:  
21450 NW WEST UNION Rd,  
HILLSBORO, OR  
97124  
1-877-814-2803

REV	DESCRIPTION	DATE	DRAWN	GOWTHAM	09-JUL-2025	DESCRIPTION		
0	INITIAL DRAWING	09-JUL-2025	CHECKED	ROB JULIEN	09-JUL-2025	EZ-TEE IPS HUB FOR GRAVITY APPLICATIONS		
			APPROVED					
			Q.A.					
			COMMENTS:			PART NUMBER		
						REV		
						ZZZZ0		
						MATERIAL :		
						SCALE: 1 : 3.75    WEIGHT:    SHEET 2 OF 2		